

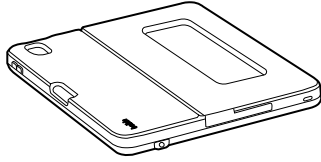

Before insertion and removal of the iPad, please disconnect and pull out the USB-C cable to prevent damage to both keyboard folio and the iPad.
キーボードフォリオとiPadの損傷を防ぐため、iPadを抜き差しする前にUSB-Cケーブルを抜いてください。

1



2

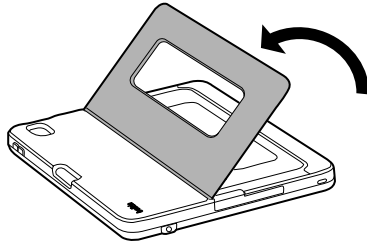

3

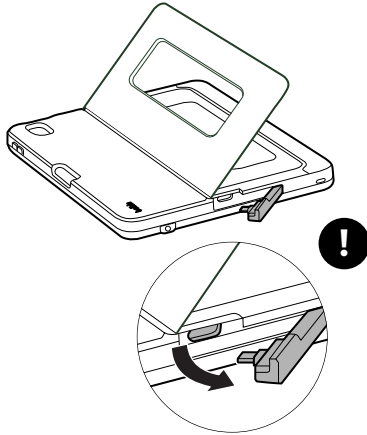

4

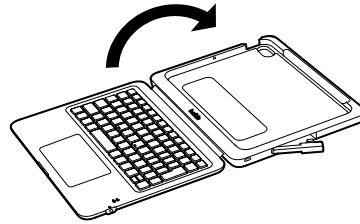

5

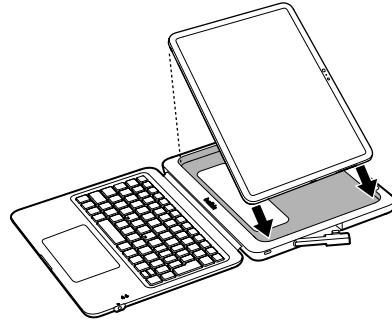

6

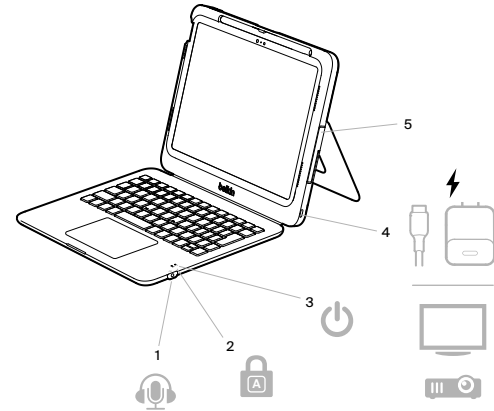
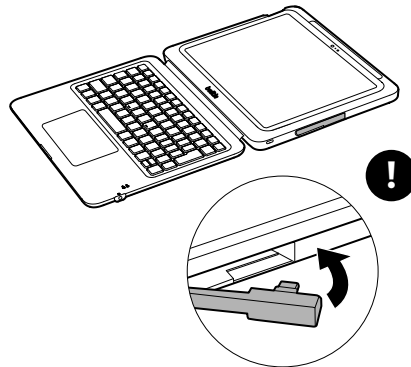

1. 3.5mm Audio
2. Caps Lock LED
3. Power LED
4. Pass through Charging / Display Port
5. USB-C cable

